

**CUCKOO**  
always new

[www.owell.hk](http://www.owell.hk)

OWELL INTERNATIONAL LIMITED

Unit 809, 8/F, Tai Tak Ind Bldg, 2-12 Kwai Fat Rd, Kwai Chung HongKong  
Customer Service : +852 23177776

00455-0003H0 Rev.0

User Manual

CP-PN011G

CP-PN011S

CP-PN011L

CUCKOO Electric Water Purifier

love

**CUCKOO**  
always new

happiness

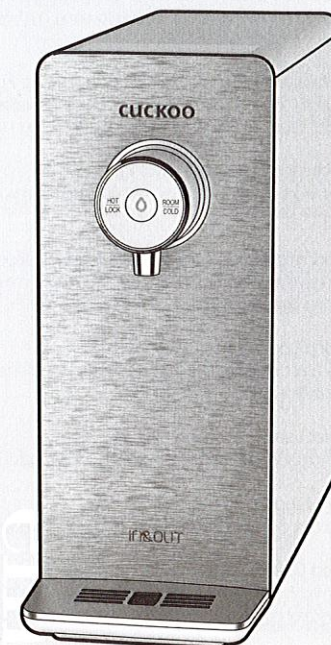

design

**CUCKOO**





Dear customers,  
Thank you for purchasing CUCKOO Water Purifier.

Please keep this manual (including the Warranty).  
This manual will be of great help when you have any question or when the functions do not work properly.

MEMO



## Characteristics and Merits of CUCKOO Water Purifier

### Product Benefits

#### ○ Nanopositive Filtering System

The Nanopositive filtering system provides clean and healthy mineral water.

#### ○ Direct-Type Water Purifier for Your Good Health

This water purifier has no water storage unit and employs an instantaneous cooling and heating method and a direct water purification system for you to drink cold water, hot water, and room temperature water right after the water passes through a filter.

#### ○ A Sophisticated Water Purifier with Multiple Functions in Slim Design

You can use cold water, room temperature water, and hot water in one water purifier, and also make more efficient use of your space with its slim and sophisticated design.

#### ○ Electrolytic Sterilization System

This product employs an electrolytic sterilization system for you to use it hygienically. You can sterilize the product anytime you want.

#### ○ Economical and Eco-Friendly Water Filtration System

We have applied a highly economical and eco-friendly water filtration system that won't waste water during the filtering process by using the Nano Positive Filter.

#### ○ Button Lock/Functional Lock

The product features a button lock and functional lock in order to prevent accidents caused by misuse by children or the elderly.

#### ○ Water Leak Prevention System

The product is made to detect/block water leaks during use to ensure safe use of the Water Purifier.

#### ○ Non-Stop Flow Function

You can continuously dispense cold water, hot water, and room temperature water.

#### ○ Fixed Quantity Flow Function

It is highly convenient since you can dispense a fixed quantity of a single cup (around 150 cc) or a half cup (around 110 cc) of cold water, hot water, and purified water.

This manual includes the warranty.

Please read this User manual before using the product. After reading this manual, keep it in a place that is easily accessible to the user for future reference.

Caution : This product is for household use, and other uses (industrial, experimental, etc.) are prohibited.

In order to use this product for a long time without malfunction, please read this User Manual.



## CONTENTS

<b>Before Use</b>	● Characteristics and Merits of CUCKOO Water Purifier	2
	Safety Warnings	4~7
	Cautions for Safe Use	8~9
	Part Names/Accessories	10~11
<b>During Use</b>	● Filtration Circuit / Filtration System	12
	Details to Check before Use	13
	How To Use	14~25
	How To Clean Tray / How To Clean Main Body	26
	How To Replace the Filters	27~28
	Expected Filter Replacement Cycle / Recommendations / Filter Arrangement	29
<b>Before Asking for Support</b>	● Please check before asking for Support	30~31
<b>Service Guide</b>	● Product Specifications	32



## Safety Warnings

MEMO



- Please comply with the 'Warnings for Safe Use' as they are provided to ensure safe and proper use of the device and prevent accidents and dangerous situations.
- The 'Warnings for Safe Use' section is divided into 'Warning' and 'Caution,' which are defined as follows:

### **Warning**

Potentially dangerous situation that can cause serious injuries or death if not avoided.

### **Caution**

Potentially dangerous situation that can cause minor injuries if not avoided.



- This symbol indicates a potentially dangerous situation under specific circumstances.
- Please read the details carefully and follow the instructions to avoid dangerous situations.



- This symbol is used to indicate actions that are 'prohibited'.



- This symbol is used to indicate 'instructed' actions.

## About the Power Supply

### **Warning**

### **(Prohibitions)**

Please use the product only with a Power Outlet exclusively for 220–240V with at least a rating of 13A and when properly grounded. Do not plug multiple devices into the same Power Outlet simultaneously.



- If you use it with a lot of products, it may cause a fire or an electric shock.
- Please check the power outlet regularly.
- If it is not properly grounded, it may cause electric shock due to short circuit.
- If there is a foreign substance or moisture on the Power Plug, wipe it thoroughly before use.

Do not bend, tie or pull the Power Cord by force.

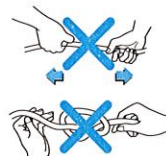

- Due to electric shock or short circuit, it may cause electric shock or fire. Please check the Power Plug frequently.

Do not use an attachable multi-power outlet.



- It may cause a fire or electric shock.

If a Power Cord or a Power Plug is damaged or when the Power Outlet is shaky, stop using the product and contact our Customer Service Center.



- If the sheath of the Power Cord is peeled off or chopped during use due to negligence, it may cause a fire or electric shock. Thus, please check the state of the Power Cord, Power Plug and Power Outlet frequently.
- To prevent dangerous situations arising from the damage of the Power Cord or the Power Plug, please contact the manufacturer, distributor or certified technician (servicemen) for replacement.
- We strongly recommend that the damaged parts be repaired at a designated service center.
- It may cause electric shock, short circuit, and fire.

If there is any moisture, dust, or foreign substances on the Power Plug, remove them with a dry cloth.



- It may cause electric shock or fire. Please check the Power Plug frequently.

If you use a movable extension cord, use only a single product for an extension cord of 13A of current capacity and ensure that it is properly grounded.



- It may cause a fire or electric shock.



## Product Specifications

Product Name		Electric Water Cooler (Instantaneous Water Heater) / CUCKOO Cold & Hot Water Purifier		
Model Name		CP-PN011G(White, Peach gold), CP-PN011S(White, Metallic silver), CP-PN011L(White, Light blue)		
Rated Voltage		Single-Phase AC 220V~240V / 50Hz		
Power Consumption		2450W ( Cold Water : 0.6A, Hot Water : 2350W)		
Water Filtration Method		Nano Positive Filtrating System		
Filter Category		Sedi Carbon Composite Filter	Natural Plus Filter	Nano Positive Filter
Materials		Polypropylene Compressed charcoal	Activated carbon Hardwood charcoal Felt Ceramic Ball	Polyester Polyamine Polypropylene
Filter Replacement Cycle		4 Months	4 Months	8 Months
Capacity	Room Water	Direct Water Supply		
	Cold Water	Direct Water Supply		
	Hot Water	Direct Water Supply		
Climate Rating		T (For temperate climate regions)		
Product	Weight	Around 10.5 kg		
	Size (W×D×H)	170 mm × 468 mm × 408 mm		
Used Tap Water Pressure	Under 0.049MPa(0.49bar)	No Installation Allowable		
	0.049MPa~0.196MPa (0.49bar~1.96bar)	Allowed to install (not allowed to install the External Valve)		
	0.196MPa(1.96bar) or higher	Proper Water Pressure (Active use of the External Valve)		
Used Environment Temperature		5 ~ 40℃		
Used Tap Water Temperature		5 ~ 35℃		

※ Specifications and other details may be subject to change without prior notice for product improvement.

## Safety Warnings

### About the Power Supply

#### Warning (Prohibitions)

When unplugging the product, make sure to hold the Power Plug, not the Power Cord.

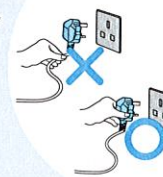

- Applying force to the Power Cord may cause electric shock or fire. Please check the Power Plug and the Power Cord frequently.

Use only one for the alternating current voltage of 220V~240V.

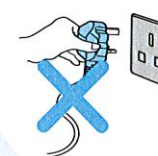

- It may cause electric shock or fire.
- The product will not work properly.
- Please check the Power Plug and the Power Cord frequently.

In case of water leaks or cleaning, first close the Tap Water Supply Valve, and then pull out the Power Plug.

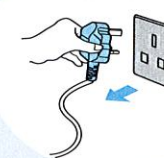

- There is a risk of electric shock or malfunction. Please check the Power Plug and the Power Cord frequently.

When inserting or pulling out the Power Plug to and from the Power Outlet, first remove any moisture on your hands and then put in or pull out the Power Plug by holding the Power Plug.



- Pulling out the Power Plug with wet hands can cause electric shock.
- Pulling the power cord by excessive force can damage the Power Cord, causing a short circuit or electric shock.
- Please check the Power Plug and the Power Cord frequently.

Make sure the Power Cord is not under a heavy object or near sharp objects. Take special caution to ensure that it is not easily damaged by your pet.



- If you do not do so, it may cause damage to the Cord, leading to electric shock or fire. Please check the Power Cord frequently.

When you do not intend to use the product for a long time, first close the Tap Water Supply Valve, and pull out the Power Plug.



- To reuse, first operate the Immediate Sterilization function and then use the product.(Refer to page 18)
- Before reuse, refer to the 'Details To Check before Use.' (page 13)

Please also unplug the product before inspection, repair or replacement of its parts.

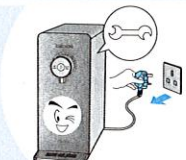

- There is a risk of malfunction or electric shock. Please check the Power Plug and the Power Cord frequently.

If water enters the power supply area, unplug the product and dry it completely before use.



- It may cause electric shock or fire. Please check the Power Plug and the Power Cord frequently.





## Safety Warnings

### Installation Guide

#### Warning (Prohibitions)

Do not install where it may be exposed to moisture, excessive dust, and splashing water.



- Install the product in a clean environment.
- It may cause a malfunction, electric shock or fire.

Install the product on a firm and flat floor with a distance of 20 cm or longer from the wall.

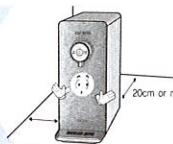

- If you do not do so, it may cause poor performance of the product.

Do not install the product near the bathroom.

Do not place it in an uneven or slanted area. Please avoid placing it on a rug, cushion or laminated floor.



- It may cause malfunction, unwanted noise or injury. Please check the product regularly if it is working properly.
- It may cause product damage and fire.
- The Purifier is a fixed product, so please use it fixed.

Do not place it in an area where there's a risk of a gas leak or near a heating device.

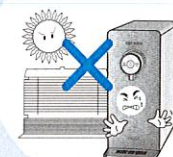

- There is a risk of explosion or fire.

Always use the waterworks for tap water, and install the Tap Water Supply Valve near the Cooling Water Pipe.



- Do not use water sources other than the tap water, such as ground water.
- Filter change cycle can vary according to the region and capacity of water use.
- Connecting the valve to the hot water pipe may cause damage to the filter or breakdown of the product.

Avoid direct sunlight and high temperature.

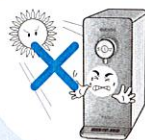

- It may cause color changes or discoloration.
- Please check the Power Cord frequently.

Make sure that the length of Tap Water Supply Tube doesn't exceed 5 m from the Tap Water Supply Valve.

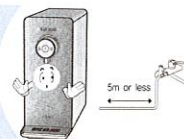

- If the tube is longer than 5 m, it may cause poor performance of the product.

Avoid places where the temperature goes below 5°C and the outdoors.

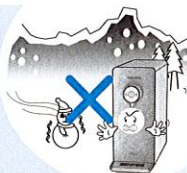

- It may cause the filter, tubing or any other components to freeze, causing malfunction of the product.
- The temperature of environment for using the product should be 5–40°C.

## Please check before asking for Support

▼ If you do not comply with this User Manual, the product may not work properly even if there is no malfunction. Please take the following measures accordingly if there is a problem with the product. If there is still a problem, please contact our Customer Service Center.

Problem	Checklist	Recommended Actions
It does not dispense enough water.	<ul style="list-style-type: none"> <li>• Have you closed the Tap Water Supply Valve?</li> <li>• Do you need to replace the filters?</li> <li>• Is the Filter Door lock opened?</li> </ul>	<ul style="list-style-type: none"> <li>• Open the Tap Water Supply Valve.</li> <li>• Replace the Filter with a genuine CUCKOO Filter.</li> <li>• Close the Filter Door lock at left side in the product. (Water is supplied to the product.)</li> </ul>
There is a loud noise coming from the product.	<ul style="list-style-type: none"> <li>• Please check if it's installed on firm, even ground.</li> <li>• Does it touch any other objects?</li> <li>• Is the Tray assembled properly?</li> <li>• Are the back surface and the side surfaces of the product in contact with the wall?</li> <li>• Are there items such as a flowerpot, books, or clock on the product?</li> </ul>	<ul style="list-style-type: none"> <li>• Install the product on a flat and solid floor.</li> <li>• Make sure it does not touch any other objects.</li> <li>• If the Tray is not properly mounted, an abnormal noise can be made. Check the state of assembly of the Tray.</li> <li>• Reinstall the product with a proper distance (20 cm) from the wall.</li> <li>• Remove the items on the product.</li> </ul>
There are floating matters in the dispensed water.	<ul style="list-style-type: none"> <li>• Do you need to replace the filters?</li> </ul>	<ul style="list-style-type: none"> <li>• Replace the Filter. (Do not use a Non-Cuckoo filter.)</li> </ul>
There are fine particles in the room water.	<ul style="list-style-type: none"> <li>• Are there bubbles?</li> </ul>	<ul style="list-style-type: none"> <li>• If there are still fine particles in the water after five minutes, immediately contact our Customer Service Center.</li> </ul>
Water is leaking from the purifier.	<ul style="list-style-type: none"> <li>• Is the assembled (connecting) part defective?</li> <li>• Is your home or the external environment humid?</li> </ul>	<ul style="list-style-type: none"> <li>• Close the Tap Water Supply Valve and unplug the product. After that, contact our Customer Service Center for service.</li> <li>• Dew condensation may occur when a cold part of the water purifier meets moisture, which is the same as if a water droplet forms on a water cup.</li> </ul>



## Please check before asking for Support

▼ If you do not comply with this User Manual, the product may not work properly even if there is no malfunction. Please take the following measures accordingly if there is a problem with the product. If there is still a problem, please contact our Customer Service Center.

Problem	Checklist	Recommended Actions
The water has bad taste and/or odor.	<ul style="list-style-type: none"> <li>Was the product left idle for a long time?</li> <li>Do you need to replace the filters?</li> </ul>	<ul style="list-style-type: none"> <li>Operate the Filter Cleaning function. (Refer to page 23)</li> <li>Contact Customer Service for filter replacement.</li> </ul>
It fails to dispense water.	<ul style="list-style-type: none"> <li>Is the Power Cord connected?</li> <li>Is the tap water supplied properly?</li> </ul>	<ul style="list-style-type: none"> <li>Connect the Power Cord.</li> <li>Open the Tap Water Supply Valve.</li> <li>Check if the water supply tube is folded.</li> <li>Check if water is cut off.</li> </ul>
	<ul style="list-style-type: none"> <li>Have you pressed the [Outflow] button properly?</li> <li>Is there water under the product?</li> <li>Do you need to replace the filters?</li> <li>Is the Filter Door lock opened?</li> </ul>	<ul style="list-style-type: none"> <li>Press the [Outflow] button properly.</li> <li>Close the Tap Water Supply Valve, unplug the product, and contact our Customer Service Center.</li> <li>Contact Customer Service for filter replacement.</li> <li>Close the Filter Door lock at left side in the product. (Water is supplied to the product.)</li> </ul>
It fails to dispense cold water.	<ul style="list-style-type: none"> <li>Have you dispensed a lot of cold water?</li> <li>Did you close the Tap Water Supply Valve?</li> <li>Is the ventilation at the back of the product good?</li> </ul>	<ul style="list-style-type: none"> <li>If a lot of cold water is dispensed, the product needs some time to recool the water.</li> <li>Check the Tap Water Supply Valve.</li> <li>Check if the radiator at the back of the product is blocked. Remove any objects blocking the radiator.</li> <li>Move the product to a place with good ventilation. (Please contact our Customer Service Center whenever you move and reinstall the product.)</li> <li>If there is excess dust in the air vents, contact our Customer Service Center.</li> </ul>
The hot water is lukewarm.	<ul style="list-style-type: none"> <li>Is it the first cup of hot water?</li> </ul>	<ul style="list-style-type: none"> <li>When you first operate the Instantaneous Hot Water function, the temperature of the first cup may be low.</li> <li>Check if the temperature of the hot water is normal from the second cup.</li> </ul>

## Safety Warnings

### During Use

#### Warning (Prohibitions)

Do not place any heating devices such as a microwave oven, electric oven or toaster, or other inflammables such as candles, gas containers, and lighters on top of the product.



- There is a risk of fire, electric shock or accidents.

Do not place chemicals, water bottles or small metal materials on top of the product.



- They could fall into the product and potentially cause a fire or damage the product.

Do not pull the Power Cord or hose, nor grab the Faucet when moving the product.

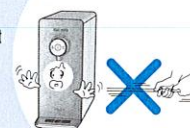

- It may cause damage to the product.

Do not disassemble or remodel the product.



- It may cause a fire or electric shock.
- Do not let anyone else other than our service technicians to disassemble or collect the product.

#### Caution (Instructions)

If water leaks from the inside of the product or water has gathered around the product, close the Tap Water Supply Valve, turn off the power supply, pull out the Power Plug, and then contact our Customer Service Center.



- There is a risk of electric shock.

If you smell burning or see smoke arising from the product, unplug it immediately and close the Tap Water Supply Valve. After that, please contact our Customer Service Center.



- It may cause a fire.

Please be careful when dispensing the hot water.



- Do not allow hot water to come in contact with the hands, and supervision is required when the appliance is being used by children or the elderly.

The product should be installed and removed by our service technicians through the Customer Service Center.

Pay attention to children or anyone who controls the Control Panel, make sure they don't use it too often.

- It may cause a disorder of the product and accidents.

Close the Tap Water Supply Valve when replacing the filters. (Tap Water Supply Valve is normally under a sink)

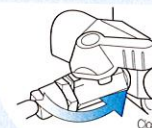

- It may cause a water leak.

Prevent the air intake hole, air discharge hole, and other gaps from being blocked or having foreign substances such as a needle, cleaning pin and metals stuck inside.

- If you do not do so, it may cause an electric shock or fire.

If you rub the veggie water valve with a brush or scrubber, the plating may be damaged and it may cause mineral adherence.





## Cautions for Safe Use

### ⚠ Caution (Instructions)

Make sure the Cooling Water Tank Cover inside the product and the Top Cover are completely closed before use.

- It's also to keep foreign material away.



If you have not used the product for a long time, first operate the Immediate Sterilization Function once before use.



- You can conveniently clean the ducts and the cooling water tank by using the Immediate Sterilization Function. (Refer to page 18)

Please avoid using the dispensed water for filling a fish bowl or an aquarium.

- The room water may not be suitable for breeding fish. They could die depending on the circumstances.

Must not use NON-Cuckoo Water Purifier filters.

- If you use a filter other than an authentic CUCKOO filter, it may cause a lowered water-purifying performance, abnormal taste of water, water leak, and malfunction of the product.

Replace the Filters according to the replacement cycle.

- If you do not do so, it may cause poor filter performance or bad odor.
- Refer to page 29 for the filter replacement cycle.



When gas or propane leaks, do not pull out the Power Cord of the product but immediately open the windows to ventilate.



- It may cause a fire or electric shock.

If you have not used the External Faucet for more than a day, it can be polluted. When reusing it, it will start dispensing after draining remaining water for about one to two minutes.

Do not lean the product at a 30-degree angle or more when moving the product.

- It may cause poor performance of the product.

### ⚠ Warnings (Prohibitions)

Do not clean the product using benzene or thinner.



- There is a risk of damage to the product.

During use, do not pull out the Hose on a rear side of the product.



- It may cause a water leak, leading to a malfunction of the product.

Do not move the product while operating the product.

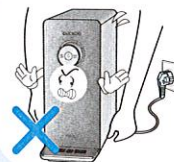

- Do not move or shake the product when it's turned on. It may cause the connecting tube to be separated, leading to a malfunction of the product and water leak.

## Expected Filter Replacement Cycle / Recommendations / Filter Arrangement



### Expected Filter Replacement Cycle

- ▶ The filter replacement cycle is set based on the amount of water filtered at home (10L per day), and the status of water supply may affect the cycle.

Filter Name	Expected Filter Replacement Cycle
Sedi Carbon Composite Filter	4 months
Natural Plus Filter	4 months
Nano Positive Filter	8 months

### Recommendations

#### ▶ Filter Replacement Cycle

- The expected filter replacement cycle is estimated by a close review of the filters for each filter to display its proper performance. This is determined based on the amount of tap water filtered for drinking (10L per day for four persons). Thus the cycle shortens as the amount used goes up.

### Filter Arrangement

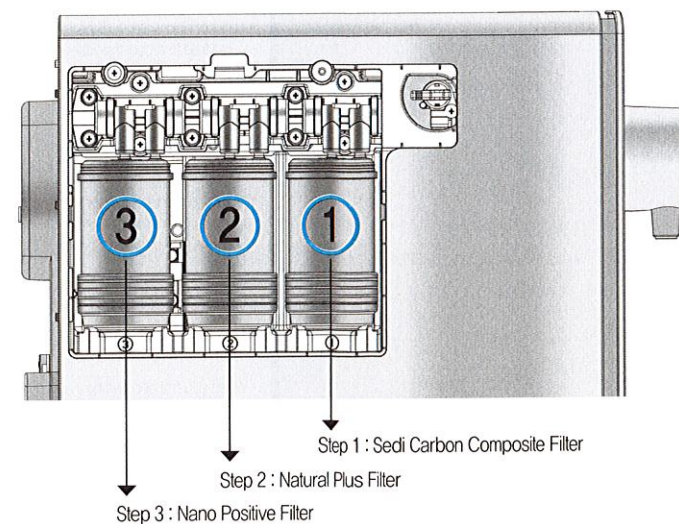



## How To Replace the Filters

(Filter replacement shall be done by Natural Care Service Team)

### How To Replace the Filters (Must not use non-CUCKOO Water Purifier filters.)

- 5 Insert the filter as in the figure, and push it into the Filter Case to connect it.

- The filters are the Sedi Carbon Composite Filter, the Natural Plus Filter, and the Nano Positive Filter from the right side to the left side. Please be careful about the order.
- Please check if the filter is properly settled on the Filter Case.

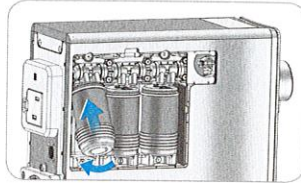

- 6 Fasten the Filter Door as in the figure.

- Fit it properly on the grooves on a bottom end to smoothen installation.

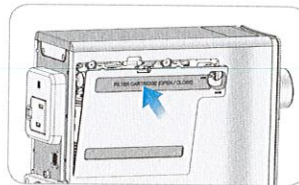

- 7 Switch the Filter Door Lock on the left of the product towards the close sign, (to let the tap water flow internally)

- When the Filter door lock is closed, water is supplied to the product.

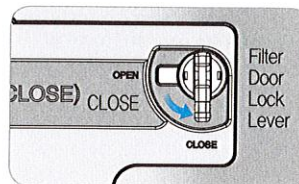

- 8 If the product is in the standby state, refer to page 20 to perform the filter reset function.
- ※ If you did not reset the filter, the filter replacement alarm may go off.
  - ※ When cleaning filters, Open the water lever and the Voice Guide will sound "Please open the Veggie water lever," then Switch the Filter Door Lock lever towards the "Close" direction.

## Cautions for Safe Use

### ⚠ Caution (Instructions)

Keep packing materials such as Styrofoam and vinyl away from children's reach.



- It may cause suffocation.

Prevent children from climbing or hanging on the product.



- It may cause the product to fall down, leading to injury of the children.

Do not connect anything other than the waterworks to the Tap Water (Drinking Water) Supply Pipe.



- Water other than the tap water (drinking water) may cause diseases.
- It may cause a malfunction or a reduced lifespan of the product.

Do not install the product in places listed below:

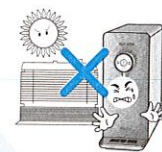

- Outdoors
- A place exposed to direct sunlight
- Near a bathroom
- In front of a cooler or a heater
- A slanted place

Avoid damaging the Refrigerant Circuit.



- It may cause a malfunction of the product.

Do not randomly connect an apparatus to reduce a pressure to the Hot Water Apparatus Pipe.

- It may cause a malfunction of the product.

Do not repeatedly operate the Hot Water Outflow and the Stop functions.



- It may cause a malfunction of the product. In particular, it may cause steam.

### During Use

This product is exclusively for 220V–240V, so always use a Power Outlet exclusively for 220V–240V while being properly grounded.

When you use an extension cord (such as a multi-power outlet), do not simultaneously connect any other product.

Failure to ground may cause electric shock due to short circuit. Be sure to only use the product after grounding.

#### 1 In case of a power outlet with a grounding terminal

When there is a grounding terminal, you can immediately use the power outlet without any extra work.

#### 2 In case of a power outlet with no grounding terminal

First, check if an earth leakage breaker is installed. If there is no earth leakage breaker, install one before using the product. If there is no earth leakage breaker, it may cause a fire.





## Part Names



## How To Replace the Filters

(Filter replacement shall be done by Natural Care Service Team)

### Part names

〈Top Side〉

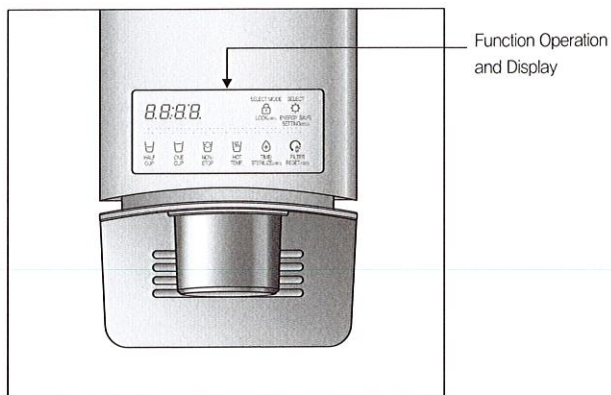

〈 Front & Back 〉

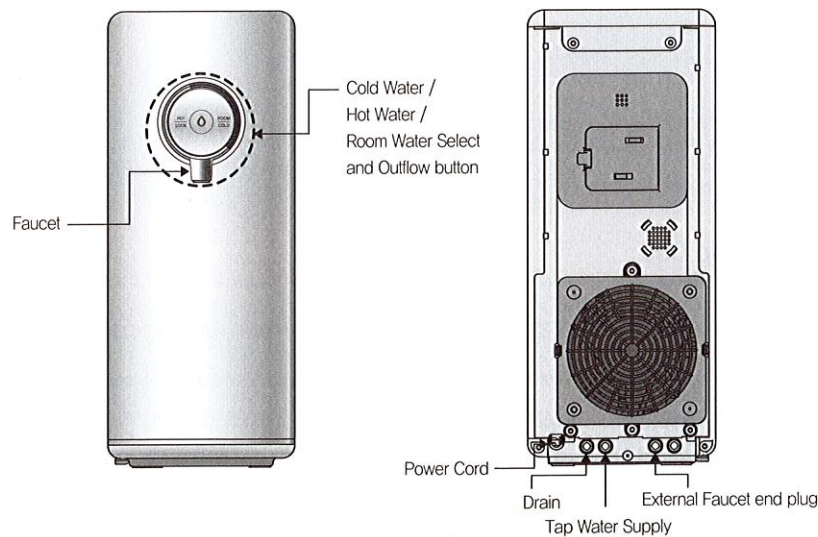

### How To Replace the Filters (Must not use non-CUCKOO Water Purifier filters.)

- 1 Switch the Filter Door Lock on the left of the product towards the open sign.

- It stops the tap water flow internally when the replacing the filter by shutting off the water supply.

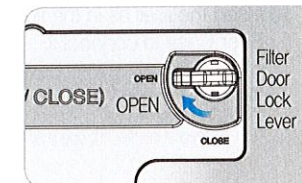

- 2 Dispense room water completely until there is no water left in the product.

- When dispense water, please use a cup or a container, etc



- 3 Press the hook and Disassemble the filter door

- Do not turn the filter door lock by force, It may cause damage to the product
- If the filter door cannot be opened, Please Switch the Filter Door Lock lever towards the "Open" direction.

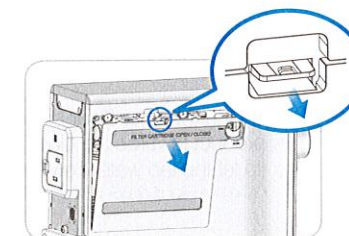

- 4 Remove the filter by lifting and pulling it.

- When you remove the filter, water gathered in the Filter Fastening Unit may leak. When water leaks, wipe it out by using a cloth, etc.

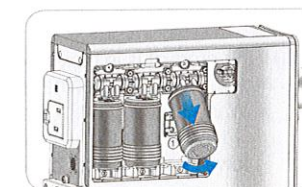





## How to Clean the Tray

### 1 Remove the Tray

- ▶ Hold and pull the Tray out of the front side of the product to separate it from the product.

※ When you pull the Tray, pull it slowly with both hands. If you strongly pull it, the water may pour out.



### 2 Remove the Tray Grille

- ▶ Then detach the Tray Grille from the Tray by taking hold of and uplift the hole at the Grille.

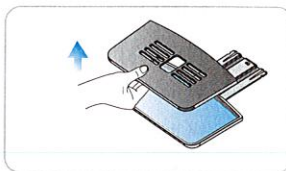

### 3 Clean the Tray

- ▶ Dispose of the stagnant water, and completely wipe it out with a soft cloth.

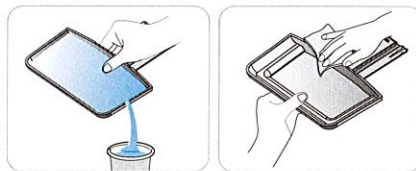

### 4 Reassemble the Tray

- ▶ After cleaning the Tray, place the Tray back in reserve order.

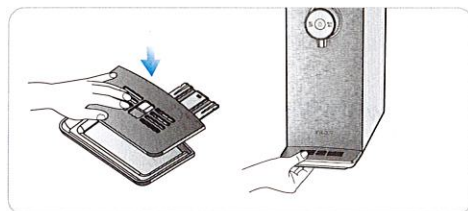

## How to Clean Main Body

### ● Wipe out with a soft dry cloth.

- ▶ Before wiping out, set the Button Lock function to prevent an incorrect operation during cleaning.
- ▶ When the product becomes severely polluted, wipe it out with a cloth with a little moisture. (Do not clean the product by using benzene, thinner, or abrasive.)



### ● Pull the Pre-Filter on a floor surface of the product to separate, wash it under running water, and then reassemble it.

- ▶ If it is not cleaned for a long time, the cool water performance may be lowered.

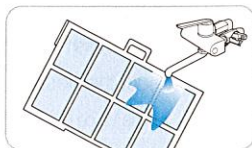

## Water Purifying

〈Details of Display Panel〉

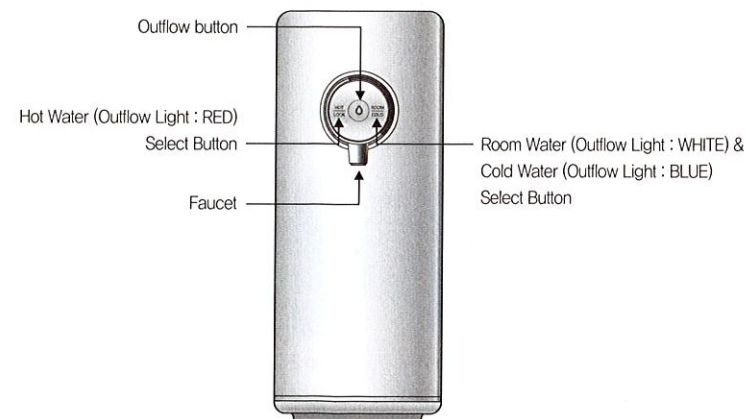
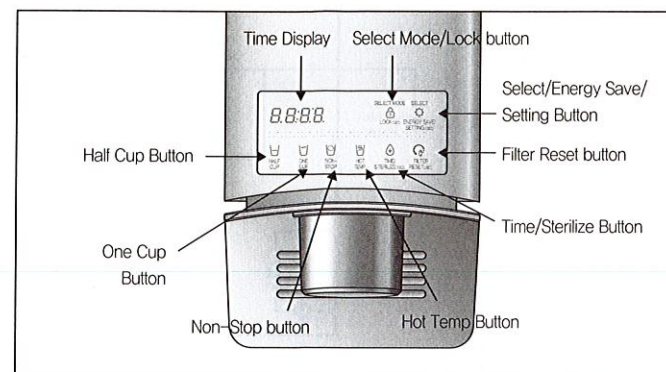

## Accessories



User Manual



Service Card



External Valve (Optional)



Sterilizing Cup

(If it is lost, contact us at +852 23177776 to purchase a new one.)





## Filtration Circuit

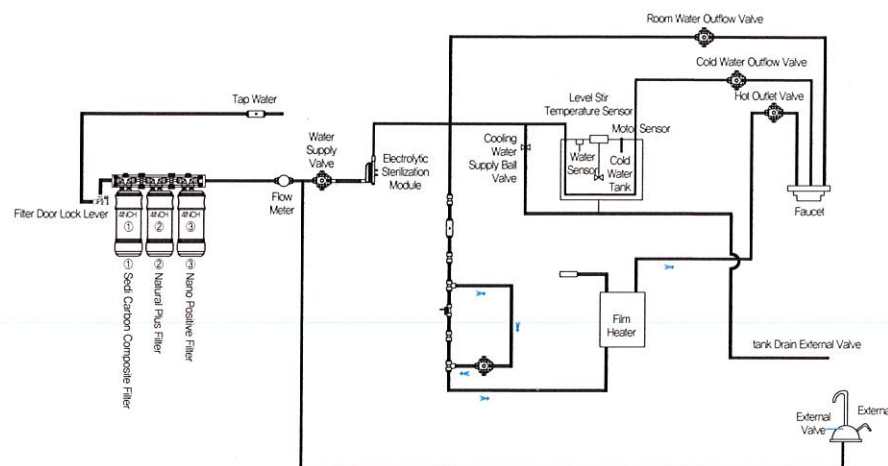

## Filtration System

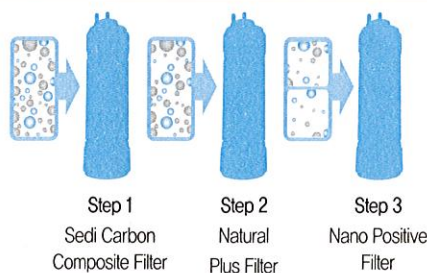

Step	Filter Name	Filter Function
Level 1	Sedi Carbon Composite Filter	Removes rust, floating matter, and residual chlorine.
Level 2	Natural Plus Filter	Removes residual chlorine and organic matter. Anti-bacterial function, Contains minerals.
Level 3	Nano Positive Filter	Removes fine particles, general germs, some heavy metals (mercury, iron, aluminum), and norovirus.

※ Using a NON-Cuckoo filter or other unauthorized filter for a long time may result in diminished filter performance.

## How To Set Current Time

- Press the [Energy Save/Setting] button for three seconds in the Waiting status.  
▶ The product will enter the User Setting mode.
- After the product has entered the User Setting Mode, press the [Lock] button eight times.  
▶ The Voice Guide will say "Present time display and setting mode."
- Press the [Energy Save/Setting] button to enter the Time Setting mode.
- Set the hour of the current time by pressing the [TIME/STERILIZE] Button.
- Set the minute of the current time by pressing the [Filter Reset] button.
- Save the current time by pressing the [Energy Save/Setting] button.  
▶ The Voice Guide will say "Set-up completed."

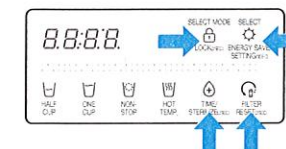

## How To Set Language

- Press the [Energy Save/Setting] button for three seconds in the Waiting status.  
▶ The product will enter the User Setting mode.
- After the product has entered the User Setting Mode, press the [Lock] button nine times.  
▶ The Voice Guide will say, "Voice selection mode."
- Press the [Energy Save/Setting] button to enter the Language Setting mode.
- Press the [Non-Stop] button to select a language.  
▶ Each time you press the button, the language will change.  
e.g.) English → Mandarin → Bahasa Malaysia → ...
- Select the desired language and save it by pressing the [Energy Save/Setting] button.  
▶ The Voice Guide will say "Set-up completed."







## How To Use

### How To Use the Filter Cleaning Function(When External Valve is installed)

- 1 Manually open the water valve. If the water valve does not open "Please open the Veggie water lever," voice guide will function.

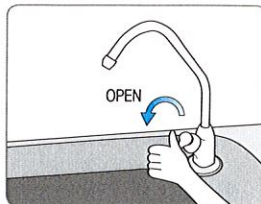

- 2 Filter cleaning in progress "Please lock the Veggie water lever," Voice guide will function Manually close the water valve.

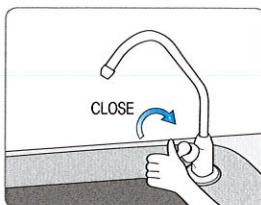

### How To Use the Filter Cleaning Function(When External Valve is not installed)

- 1 Manually open the water valve. If the water valve does not open "Please open the Veggie water lever," voice guide will function.

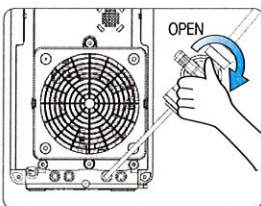

- 2 Filter cleaning in progress "Please lock the Veggie water lever," Voice guide will function Manually close the ball valve.

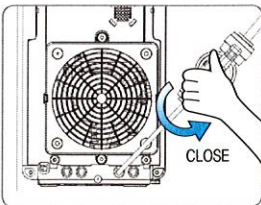

## Details to Check before Use

### Details to Check before Use

- 1 Open the Tap Water Supply Valve.
  - Open the Tap Water Supply Valve, and check if there is water leak on each connection part.
  - Tap Water Supply Valve and the Tap Water Input and the Exterior of the product.

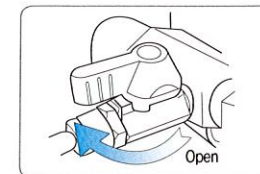

- 2 Switch the Filter Door Lock on the left of the product towards the close sign, (to let the tap water flow internally)
  - When the Filter door lock is closed, water is supplied to the product.

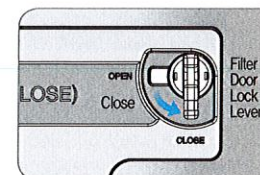

- 3 Plug in the product.
  - This product exclusively uses 220V~240V 50Hz, Please make sure to plug it into the proper power outlet.

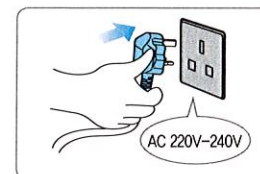

- 4 Empty the tray on a regular basis.

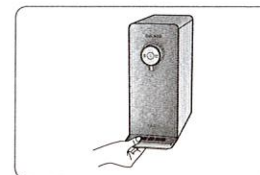





## How to Set Functions

## 1 Waiting Mode

- ▶ It is an Outflow Waiting mode to dispense cold water, room temperature water, and hot water. The Display lights on the front are turned ON according to the selected function such as either cold water or room temperature water.

## 2 User Setting Mode

- ▶ You can set the function by pressing the [Energy Save/Setting] button for three seconds in the Waiting status.

User Setting Mode	
When pressing [Select Mode/Lock] once	Filter replacement alarm setting
When pressing [Select Mode/Lock] twice	Sterilization alarm setting
When pressing [Select Mode/Lock] three times	Single Cup Outflow Setting Function
When pressing [Select Mode/Lock] four times	Half Cup Outflow Setting Function
When pressing [Select Mode/Lock] five times	Voice Volume Setting Function
When pressing [Select Mode/Lock] six times	Mood Lamp ON/OFF Function
When pressing [Select Mode/Lock] seven times	Automatic Filter Cleaning Function
When pressing [Select Mode/Lock] eight times	Current Time Setting Function
When pressing [Select Mode/Lock] nine times	Language Setting Function

## 3 Fixed Quantity Outflow

- ▶ Press the [Outflow] button once and then the water of the selected fixed quantity will be dispensed.
- ▶ Select the [Half Cup] button and press the [Outflow] button for 110cc of water to be dispensed.
- ▶ Select the [One Cup] button and press the [Outflow] button for 150cc of water to be dispensed.
- ▶ Select the [Non-Stop] Flow button and press the [Outflow] button for the water to be dispensed continuously.

## 4 Manual Outflow

- ▶ The water is dispensed while you are pressing the [Outflow] button.
- ▶ Press the [Outflow] button for two seconds, and the product will be converted into the Manual Outflow status. And the water will be dispensed while you are pressing the [Outflow] button.



## How To Use the Mood Lamp Function

- Press the [Energy Save/Setting] button for three seconds in the Waiting status.
  - ▶ The product will enter the User Setting mode.
- After the product has entered the User Setting Mode, press the [Lock] button six times.
  - ▶ The Voice Guide will say "Mood lamp setting mode."
- Press the [Energy Save/Setting] button to enter the Mood Lamp Setting mode.
- Select the Mood Lamp function by pressing the [Non-Stop] button.
  - ▶ Each time you press the button, the Display will repeat showing ON and OFF.  
e.g.) On → OFF → ON → OFF → ...
- Select ON or OFF of the Mood Lamp and save it by pressing the [Energy Save/Setting] button.
  - ▶ The Voice Guide will say "Set-up completed."

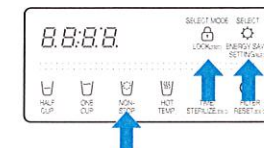

## How To Use the Filter Cleaning Function

- Press the [Energy Save/Setting] button for three seconds in the Waiting status.
  - ▶ The product will enter the User Setting mode.
  - ▶ After the product has entered the User Setting Mode, press the [Lock] button seven times.
  - ▶ The Voice Guide will say, "Automatic filter flushing function."
- Press the [Energy Save/Setting] button.
  - ▶ The Voice Guide will say, "Start auto filter cleaning," and the product will clean the filters.
  - ▶ The Display Panel will show the cleaning time.
  - ▶ Manually open the water valve or ball valve. If the water valve does not open "Please open the Veggie water lever," voice guide will function.
  - ▶ Filter cleaning in progress "Please lock the Veggie water lever," Voice guide will function Manually close the water valve or the ball valve, (See How to clean the filter, page 24)
- When the filter is cleaned, the voice guidance "Auto filter cleaning completed" will function, will be ready for water outflow.
- To cancel the filter cleaning function, press the [Outflow] button during filter cleaning.
  - ▶ "Auto filter cleaning stopped" voice guide will function.
- The time required for filter cleaning depends on the water pressure of the raw water, it takes about 10~15 minutes.







## How To Use

### How To Change Fixed Amount of Outflow

- Press the [Energy Save/Setting] button for three seconds in the Waiting status.  
▶ The product will enter the User Setting mode.
- After the product enters the User Setting mode, press the [Lock] button three times [One cup volume] or four times [Half cup volume].  
▶ The Voice Guide will say, "Half cup, 1 cup volume setting mode."
- Press the [Energy Save/Setting] button to enter the Outflow Volume Setting mode.
- Press the [Non-Stop] button to set a desired outflow volume.  
▶ Each time you press the button, the Display will repeat changing from 0 (Standard) to Up and Down.

ex) -- 0 --> ==UP--> ==dn--

Fixed Amount	Quantity of Outflow (cc)		
	Down	Standard	Up
Half Cup	About 95 cc	About 110 cc	About 125 cc
One Cup	About 130 cc	About 150 cc	About 170 cc

- Select a desired outflow volume, and save the information by pressing the [Energy Save/Setting] button.  
▶ The Voice Guide will say "Set-up completed."

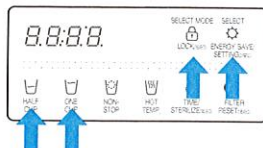

### How to Change Voice Volume

- Press the [Energy Save/Setting] button for three seconds in the Waiting status.  
▶ The product will enter the User Setting mode.
- After the product has entered the User Setting Mode, press the [Lock] button three times.  
▶ The Voice Guide will say "Voice volume setting mode."
- Press the [Energy Save/Setting] button to enter the Voice Volume Setting mode.
- Set the Voice Volume Step by pressing the [Non-Stop] button.  
▶ Each time you press the button, the step will be changed by one step from the previously set voice level, e.g.) Step 4 → Step 5 → OFF → Step 1 → Step 2 → ...  
▶ In order to set the maximum volume, select the set value to be 5.  
▶ If you do not want to use the Voice Guide, select the set value to be OFF.
- Select a desired voice volume, and save the information by pressing the [Energy Save/Setting] button.  
▶ The Voice Guide will say "Set-up completed."

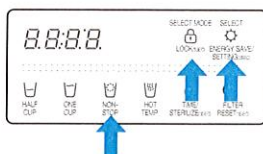

## How To Use

### How to Set Cold Water Function

- If the Cold Water function is turned OFF, press the [Room/Cold] button for three seconds to turn ON the Cold Water function.  
▶ While you are pressing the [Room/Cold] button, the Voice Guide will say "Selecting Cold water function."  
▶ When the Cold Water function is turned ON, the word "ON" will be displayed, and the Voice Guide will say "Cold water function selected."
- If you do not want to use the cold water, turn OFF the Cold Water function by pressing the [Room/Cold] button for three seconds while the Cold Water function is ON.  
▶ While you are pressing the [Room/Cold] button, the Voice Guide will say "Canceling Cold water function."  
▶ When the Cold Water function is turned OFF, the word "OFF" will be displayed, and the Voice Guide will say "Cold water function Cancelled."  
▶ If you press the [Room/Cold] button while the Cold Water function is turned OFF, the Voice Guide will say "Cold water function off." "Please turn on cold water function before use."

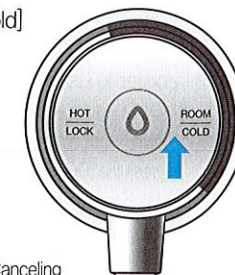

※ You can dispense the cold water in about one hour after you have turned ON the Cold Water function.  
※ The function is set to be ON as the default setting of the product.

### How To Dispense Cold Water

- Press the [Room/Cold] button to select cold water.  
▶ The Voice Guide will say "Cold Water."
- In order to use the fixed quantity outflow,  
▶ Select the desired quantity from among the buttons of [Half Cup], [One Cup] and [Non-Stop].  
▶ Press the [Outflow] button once. The cold water will be dispensed.  
▶ When the selected quantity of water is completely dispensed, the water dispensing will end.  
▶ If you press the [Outflow] button or any other button while the product is dispensing the selected quantity of water, the water dispensing process will end.
- If you want to operate the Manual Outflow,  
▶ Press the [Outflow] button. The cold water will be dispensed.  
▶ If you press the [Outflow] button for two seconds or longer, the status of the product will be changed into the Manual Outflow status.  
▶ The Voice Guide will say "Water dispensing during pressing."  
▶ If you stop pressing the [Outflow] button during the Manual Outflow, the water dispensing will end.
- While the cold water is being dispensed, the Blue Mood light on the Faucet will be turned ON. (When the Mood function is turned OFF, the light will not be turned ON.)

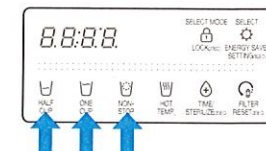
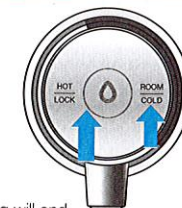

※ After initially installing the product, you need to separately put cooling water in.  
(If cooling water is not put in, the Cold Water function will not work normally.)



### How To Dispense Room Water

- 1 Press the [Room/Cold] button to select room water.
  - ▶ The Voice Guide will say "Room Water."
- 2 In order to use the fixed quantity outflow,
  - ▶ Select the desired quantity from among the buttons of [Half Cup], [One Cup] and [Non-Stop].
  - ▶ Press the [Outflow] button once. The room water will be dispensed.
  - ▶ When the selected quantity of water is completely dispensed, the water dispensing will end.
  - ▶ If you press the [Outflow] button or the selected fixed quantity button again while the product is dispensing the fixed quantity of water, the water dispensing will be ended.
- 3 If you want to operate the Manual Outflow,
  - ▶ Press the [Outflow] button. The room water will be dispensed.
  - ▶ If you keep pressing the [Outflow] button for two seconds or longer, the product will be changed into the Manual Outflow status.
  - ▶ The Voice Guide will say "Water dispensing during pressing."
  - ▶ If you stop pressing the [Outflow] button during the Manual Outflow, the water dispensing will end.
- 4 While the room water is being dispensed, the Green Mood Light on the Faucet will be turned ON. (When the Mood function is turned OFF, the light will not be turned ON.)

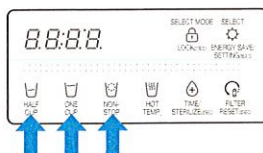

### How to Set Hot Water Lock Function

This function prevents children from randomly operating the product and getting burnt. If this function is selected, the [Hot/Lock] button won't work.

- 1 If you press the [Hot/Lock] button for three seconds in the Waiting status, the Hot Water Lock will be selected.
  - ▶ If you press the [Hot/Lock] button in the Hot Water Lock status, "Loc\_" will be displayed and the Voice Guide will say "Child lock on."
  - ▶ If you press the [Hot/Lock] button for three seconds in the Hot Water Lock status, "Un\_Loc\_" will be displayed and the Hot Water Lock will be released.



### To use hot water after installation

- 1 Press the [Hot/Lock] water button and press the [Outflow] button.
  - ▶ "Start water input installation check" voice will follow
  - ▶ Water outflow will stop when product check is done
  - ▶ "Product installed successfully" voice will follow
- 2 Hot water can be used after product installation is completed.



### When using filter alarm

- 1 In standby mode, press the [Energy Save/Setting] button for 3 seconds.
    - ▶ Enter the user setting mode.
  - 2 After entering user setting mode, press the [Lock] button once.
    - ▶ "Filter replacement alarm setting mode" voice guide will function
  - 3 Press the [Energy Save/Setting] button to enter the filter replacement notification setting mode.
  - 4 Press the [Non-Stop] button to set the filter replacement alarm function.
    - ▶ Repeats ON / OFF every time button is pressed.
    - Ex) ON → OFF → ON → OFF → ...
  - 5 Select filter change notification ON / OFF and press [Energy Save/Setting] button to save.
    - ▶ "Set-up completed" voice guide will function
- ※ When the function is turned OFF, the filter replacement alarm does not operate.

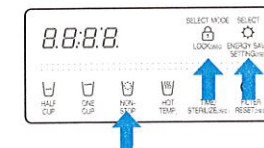

### When wanting to use Sterilization recommended alarm

- 1 In standby mode, press the [Energy Save/Setting] button for 3 seconds.
    - ▶ Enter the user setting mode.
  - 2 After entering user setting mode, press the [Lock] button twice.
    - ▶ "Sterilization Kit Module" voice will function
  - 3 Press the [Energy Save/Setting] button to enter sterilizing notification setting mode.
  - 4 Press [Non-Stop] button to cancel Sterilization recommended alarm notification.
    - ▶ Repeat ON / OFF every time button is pressed.
    - Ex) ON → OFF → ON → OFF → ...
  - 5 Select sterilization recommended alarm ON / OFF and press [Energy Save/Setting] button to save.
    - ▶ "Set-up completed" voice will function.
- ※ Sterilization recommended alarm will not function when turned OFF.

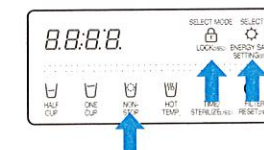





## How To Use

### To Use the Filter Reset Function

- 1 Press the [Filter Reset] button for three seconds in the Waiting status.
  - ▶ The Voice Guide will say, "Start reset."
- 2 After the Reset is completed, the Voice Guide will say, "Reset completed," and "Start auto filter cleaning," and the product will clean the filters.
  - ▶ The Display Panel will show the cleaning time.
  - ▶ Manually open the water valve or ball valve. If the water valve does not open "Please open the Veggie water lever," voice guide will follow.
  - ▶ Filter cleaning in progress "Please lock the Veggie water lever." Voice guide will function Manually close the water valve or the ball valve.(See How to clean the filter, page 24)
- 3 When the cleaning process is done, the voice guidance "Auto filter cleaning completed" will follow, the products will be ready for water outflow.
- 4 To cancel the filter cleaning function, press the [Outflow] button during filter cleaning.
  - ▶ "Auto filter cleaning stopped" voice guide will function.
- 5 The time required for filter cleaning depends on the water pressure of the raw water, it takes about 10~15 minutes.
  - ▶ When cleaning filters, Open the water lever and the Voice Guide will sound "Please open the Veggie water lever," then Switch the Filter Door Lock lever towards the "Close" direction.

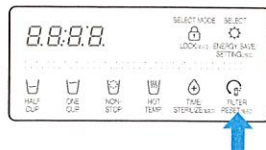

## How To Use

### How to Use Hot Water

- 1 Select the hot water function by pressing the [Hot/Lock] button.
  - ▶ The Voice Guide will say "Hot Water."
- 2 In order to use the fixed quantity outflow,
  - ▶ Select the desired quantity from among the buttons of [Half Cup], [One Cup] and [Non-Stop]
  - ▶ Press the [Outflow] button once. After preheating, the hot water will be dispensed.
  - ▶ When the selected quantity of water is completely dispensed, the water dispensing will end.
  - ▶ If you press the [Outflow] button or any other button while the product is dispensing the chosen quantity of water, the water dispensing will end.
- 3 If you want to operate the Manual Outflow,
  - ▶ Press the [Outflow] button. Hot water will be dispensed.
  - ▶ If you press the [Outflow] button for two seconds or longer, the product will be set to Manual Outflow status.
  - ▶ The Voice Guide will say "Water dispensing during pressing."
  - ▶ If you stop pressing the [Outflow] button during the Manual Outflow, the water dispensing will be ended.
- 4 While the hot water is being dispensed, the Red Mood Light on the Faucet will be turned ON. (When the Mood function is turned OFF, the light will not be turned ON.)
  - ※ There is risk of burns due to spattering of water from the product. Thus, please put the cup near the Faucet.
  - ※ After the product is installed and you dispense the first cup of hot water, lukewarm water will be dispensed. (After the first cup, hot water will be dispensed.)

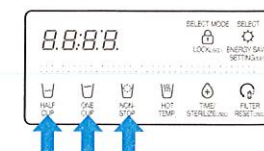
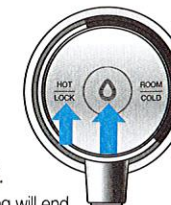

### How to check filter usage level

- 1 Notification of Time to Replace Filters through Three-Colored LEDs (Mood lights) on the Faucet
  - ▶ LED OFF → Sky-Blue → Yellow → Purple  
(As the use volume of filters increases, the color changes consecutively.)
- 2 Notification of Time to Replace Filters through the [Filter Reset] button Display Light
  - ▶ When you press the [Filter Reset] button while the [Filter Reset] button Display Light is ON, the Voice Guide will say, "Filter replacement is required."
- 3 Notification of Time to Replace Through Voice in Case of Outflow
  - ▶ When water is being dispensed, the Voice Guide will say, "Filter replacement is required," e.g.) In case of the first outflow, the Voice Guide will say so only once a day.
  - ※ When the Voice for replacing a filter is emitted, contact our Natural Manager to replace the filter. (+852 23177776)

### How To Set Hot Water Temperature (Custom Hot Water)

- 1 ▶ Each time you press the [Hot Temp] button, the temperature of hot water will be changed by around 10°C.  
40°C → 50°C → 60°C → 70°C → HOT (Maximum Temperature) ...
- ▶ Select the [Non-Stop] button and press the [Outflow] button, and then the selected temperature of hot water will be dispensed.
- ▶ If you press the [Outflow] button or any other button while the product is dispensing hot water, the water dispensing will end.

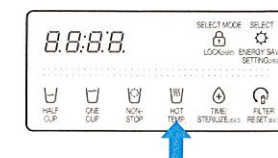



### How To Use the Sterilization Preset function

- 1 If the [Time/Sterilize] Button Display Light is turned ON in the Waiting status, the Sterilization Preset function is set to be used.
- 2 Press the [Time/Sterilize] Button while the [Time/Sterilize] Button Display Light is turned OFF.
  - ▶ The Voice Guide will say "Auto Sterilization Reservation Set-up Completed,"
  - ▶ The Sterilization/Preset Button Display Light will be turned ON.
- 3 Select the desired preset time by pressing the [Time/Sterilize] Button.
  - ▶ Each time you press the [Time/Sterilize] Button, the preset time will be changed by one hour.  
(After one hour → After two hours → ... → After 10 hours → After one hour → ...)
- 4 After selecting the desired Sterilization Preset time, save the preset time by pressing the [Energy Save/Setting] button.  
(When you use the Sterilization Preset function, always mount the Sterilizing Cup.)



### How To Use the Immediate Sterilization function

- 1 Put the Sterilizing Cup.
- 2 Press the [Time/Sterilize] Button for about three seconds in the Waiting status.
  - ▶ The product will immediately start the sterilization, and the Voice Guide will say "Start Auto Sterilization."
  - ▶ The [Time/Sterilize] Button Display Light will be turned ON, and the sterilization progress will be displayed.
- 3 In order to cancel the sterilization operation, press the [Time/Sterilize] Button while the product is operating the sterilization.
  - ▶ The Voice Guide will say "Auto Sterilization Cancelled" and the sterilization cancellation will be operated.
  - ▶ The Display Panel will show the sterilization cancellation status.
    - ※ After the operation is completed, remove the Sterilizing Cup.
    - ※ Sterilizing water is not drinking water. Prevent anyone from drinking the sterilizing water.

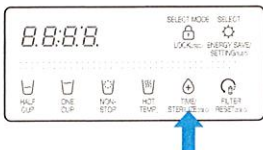

### When Sterilization Recommended Alarm is prolonged.

- 1 Sterilization function unused for a prolonged amount of time will indicate condition via [Time / Sterilize] button indicator.
  - ▶ If you do not use sterilization for a long time, The button indicator flashes three times.

### How To Use the Energy Save function

This is a function to save energy by reducing the brightness of the Display Lights.

- 1 Press the [Energy Save/Setting] button while the [Energy Save/Setting] Display Light is turned OFF.
  - ▶ The [Energy Save/Setting] Display Light will be turned ON, and in one second, all Display Lights will be dark.
  - ▶ The Voice Guide will say "Energy-Eye Function Selected."
  - ▶ While the Energy Save function is working, if you press the button, the Display Lights will be bright, (if the button is not pressed for a certain time, the Display Lights will be dark again.)
- 2 If you press the [Energy Save/Setting] button while the [Energy Save/Setting] Display Light is turned ON, the Energy Save function will be canceled.
  - ▶ The [Energy Save/Setting] Display Light will be turned OFF, and in one second, all Display Lights will be bright.
  - ▶ The Voice Guide will say "Energy-Eye Function Cancelled."



### How To Use the Button Lock function

This is a function to prevent the random control by children, etc. and to clean the product.

If this function is selected, the input of all the buttons will be blocked.

- 1 If you press the [Lock] button for three seconds in the Waiting status, the Button Lock will be selected.
  - ▶ If you press a button in the Button Lock status, "Loc\_" will be displayed and the Voice Guide will say "Button is being locked."
  - ▶ If you press the [Lock] button for three seconds in the Button Lock status, "Un\_Loc\_" will be displayed and the Button Lock will be released.

